



Waterco Case Study

London Docks, (London, UK)

# Water for wellbeing London Docks, (London, UK)

“ *The heart of any swimming pool is the filtration and we insist on the best as that is what our clients expect, and for this reason we have and will only use Waterco filtration and pumps.* ”

*says Ryan Fronda,  
Aqua Platinum Projects managing director*

- DESTINATION DEVELOPMENT IN ONE OF LONDON'S MOST ICONIC LOCATIONS
- WATERCO'S ROBUST AND RELIABLE FILTRATION SOLUTIONS THE FIRST AND ONLY CHOICE
- A PLACE WHERE CHILDREN CAN LEARN TO SWIM, STRESSES WILL BE SOOTHED AWAY, AND MEMORIES MADE

## **Setting: A modern rebirth of the historic London Docks**

With its self-contained wharves, secure warehouses, underground vaults and acres of open water, London's historic docks in Wapping once played a critical role in the city's international trade of luxury commodities like coffee and cocoa. Closed to shipping since 1969, the area has attracted a series of new developments, the latest being London Dock by St George of the Berkeley Group.



*The Health and Fitness Suite at London Docks is billed as a place where you can get in shape or soothe away the stresses of the day.*



*The pool features a vitality spa located at one end comprising of a number of spa jets and two stainless steel neck massagers.*

Neighbouring world-famous landmarks including Tower Bridge, the Tower of London and the River Thames, London Dock is a mixed-use “destination” development containing luxury apartments and penthouses, beautifully landscaped open spaces, water gardens, central squares and boulevards lined with shops, bars and restaurants.

**Challenge: Sanitising a 20-metre indoor swimming pool without harsh chemicals**

The Health and Fitness Suite at London Docks is billed as “a place where you can get in shape or soothe away the stresses of the day”. It includes a number of purpose-built amenities, such as a squash court, fully equipped gym, and fully tiled 20-metre indoor swimming pool. The pool features a vitality spa located at one end comprising of a number of spa jets and two stainless steel neck massagers.

**Solution: Waterco’s robust and reliable pool filtration products**

Designed and built by [Aqua Platinum Projects](#) in conjunction with its supplier [Paramount Pools](#), the swimming pool and vitality spa needed a robust and reliable filtration system that would maintain crystal clear, healthy pool water year-round for residents.

“Being a prestigious development in the heart of London, the pool equipment had to be of the highest quality and that’s why Waterco was our preferred choice,” says Aqua Platinum Projects managing director Ryan Fronda.

“Knowing Waterco equipment has been manufactured and supplied for over 30 years all over the world and in many different applications, and has a base in the UK, meant that we have full confidence in both the supply, quality of the product, and service.”

As a result, Aqua Platinum Projects installed the following Waterco products:

**Waterco equipment Main Pool - 145m<sup>3</sup>:**

2 x SMDD1200 Micron Commercial Sand Filters and 2 x 6HP Hydrostar Commercial Pumps.

**Waterco equipment Vitality Spa - 12m<sup>3</sup>:**

2 x SMDD1200 Micron Commercial Sand Filters and 2 x 4HP Hydrostar Commercial Pumps, along with 2 x Hydrostorm 1.5HP pumps for the neck massagers and 2 x 2.0HP Hydrostorm pumps to operate the spa jets.

“The SMDD range of Micron commercial filters were chosen for a number of reasons including their unique ‘fishtail lateral arrangement’ rather than the standard star configuration common in the cheaper models of commercial filters available,” explains Waterco CEO Tony Fisher.

“The star configuration is generally only used on residential-sized filters. The ‘fishtail lateral arrangement’ results in superior filtration and reduced backwashing times, saving 1,000’s of litres of water over the year and long with the 1.2m bed depth ensures that the highest level of filtration is guaranteed for years to come.”

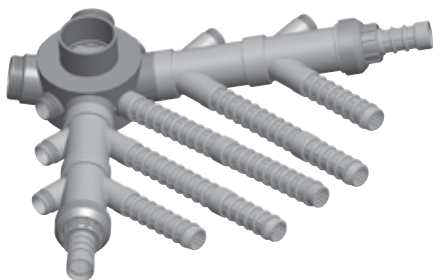

*Waterco's unique "fish tail" or "fish bone" lateral configuration eliminates this problem by providing effective coverage of the filter bed and balanced water flow.*



*The SMDD range of Micron commercial filters were chosen because of their unique fishtail lateral arrangement.*

The pumps chosen were the high-quality Waterco Hydrostar and Hydrostorm commercial pumps, which are specifically designed to meet the demands of the commercial market in regard to performance, reliability and quietness.

“They are a perfect match for the SMDD range of Micron filters,” says Tony.

**Conclusion: Australian filtration innovation at the heart of London's revitalisation**

At London Docks, arguably one of the city's biggest redevelopments, expectations are high for the “hotel-style” residents' facilities and amenities.

“When Waterco was asked to be involved in such a fantastic job, we were more than delighted,” says Tony.

One thing is for sure - the Health and Fitness Suite's luxury swimming pool will become a place where children will learn to swim, stresses will be soothed away, and memories made.

“The heart of any swimming pool is the filtration and we insist on the best as that is what our clients expect, and for this reason we have and will only use Waterco filtration and pumps,” says Ryan.

[www.waterco.com](http://www.waterco.com)  
[www.aquaplatinumprojects.co.uk](http://www.aquaplatinumprojects.co.uk)  
[www.paramountpools.co.uk](http://www.paramountpools.co.uk)



*Waterco Hydrostar and Hydrostorm commercial pumps, which are specifically designed to meet the demands of the commercial market in regard to performance, reliability and quietness.*